

Environmental Information for Customers in the European



European Directive 2002/96/EC requires that the equipment bearing this symbol on the product and/or its packaging must not be disposed of with unsorted municipal waste. The symbol indicates that this product should be disposed of separately from regular household waste streams. It is your responsibility to dispose of this and other electric and electronic equipment via designated collection facilities appointed by the government or local authorities. Correct disposal and recycling will help prevent potential negative consequences to the environment and human health.

For more detailed information about the disposal of your old equipment, please contact your local authorities, waste disposal service, or the shop where you purchased the product.

Sales & Technical Helplines

Our Sales & Technical helplines are open
Monday to Friday from 8.00am to 5.00pm

SALES



++44 (0)1604 589414 (and press option 1)



info@ultrasecuredirect.com

TECHNICAL



++44 (0)1604 589414 (and press option 2)



technical@ultrasecuredirect.com

ULTRA SECURE LTD,

9-10 RYEHILL COURT,

LODGE FARM I/E, NORTHAMPTON, NN5 7EU

UNITED KINGDOM

www.ultrasecuredirect.com

UltraSecure

PROTECT 800

Wireless Outdoor Receiver

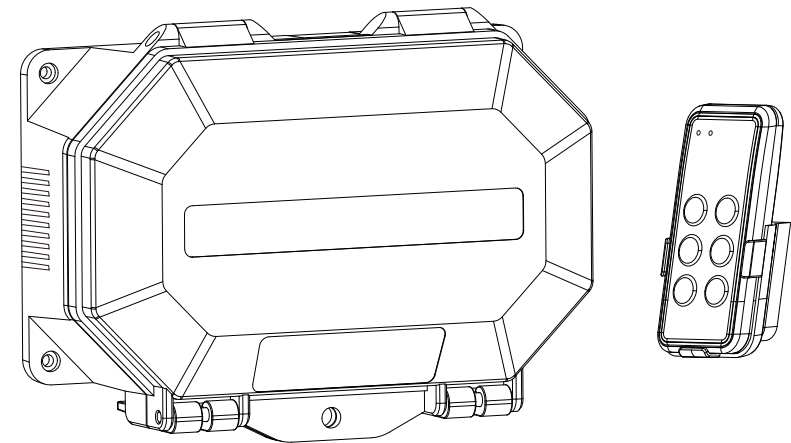

User Manual

Features

Weatherproof Outdoor Receiver

Programme up to 8 Transmitters

Two Zones with Four Channels

12v Output per Zone

Adjustable Output per Zone

Battery Powered Remote Control

Multiple Remote controls

SOS Function

Operation

Turn on and turn off the Floodlight or other 12v accessory

Press the SOS button in the corresponding zone, The transmission indicator will light up 1 sec and then turn off. If the control box receives successfully, the feedback indicator will light up 1 sec.

Press the "OFF" button to turn off the 12v supply, when the accessory is on.

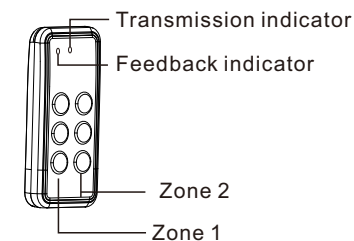

Arming and Disarming the controller

Press the "ON" button once to set the receiver box to arming mode. The floodlight will turn on, and turn off after the setting time when the corresponding zone triggered.

Press the "OFF" button to set the receiver box to disarm mode. The floodlight do not take any action when the corresponding zone triggered.

To prevent false triggering, the remote buttons are designed to be pressed for at least 1 second to function

Battery Low

When the remote control button is pressed, the transmission indicator will blink a few times after transmission. It indicates that the remote control battery is low. Replace the batteries as soon as possible.

Specification

Power supply: 12V 5A

Output Power: 12V / 20W (x2) MAX.

Transmission: 800m

Deleting a Transmitter

First, Press and hold the 'Learning' button for 3 seconds to enter the Pairing mode. Press the 'Pairing button to select the position you want to delete. Press " Clear" button 3 seconds. The LED will blink 5 time to indicate the sensor on this position has been deleted.

12v Output Duration

The duration of the 12v output for each zone can be set in the following way:

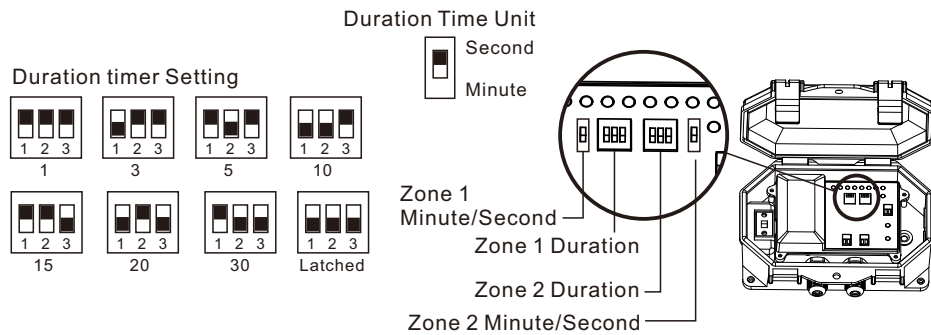

When a sensor is triggered, 12v will be supplied for the duration time been set. Latched means that when triggered, the output will remain until the remote control's OFF button is pressed.

Duplicate the Remote

When you need additional remotes to manage the control box. You can duplicate the existing remote controller's codes to a new remote controller.

Open the battery cover of new remote controller.

Take out one battery, press and hold the any 'ON' button of the remote controller and insert the battery.

Press any button of the existing remote controller (Paired remote)

* Now you can test if the new remote can control the control box.

* Multiple remotes can be duplicated.

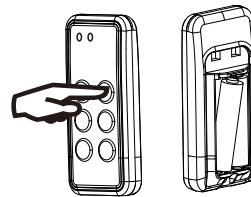

Press and hold the "ON" button and insert battery.

Parts & Function

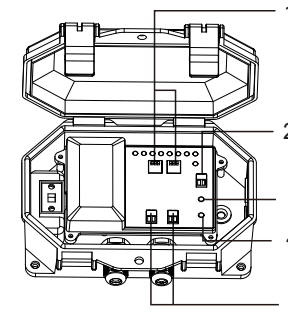
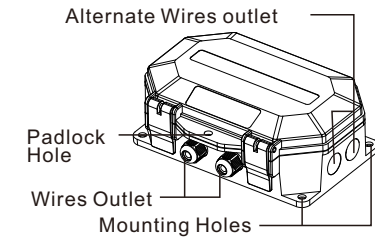

- 1) Duration Timer
- 2) Power In
- 3) Pairing Button
- 4) Clear Button
- 5) Output Terminal

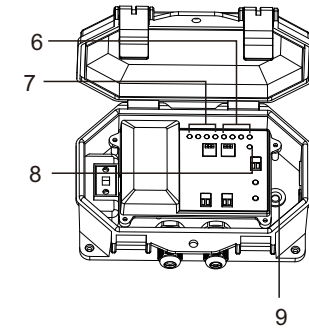

- 6) Zone 2 LED Indicators
- 7) Zone 1 LED Indicators
- 8) Remote Indicator
- 9) Wire Outlet

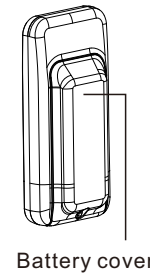

Battery cover



Battery compartment

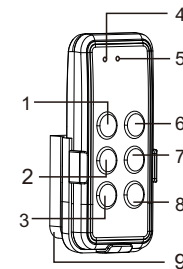

- 1) Zone 1 ON
- 2) Zone 1 SOS
- 3) Zone 1 OFF
- 4) Feedback Indicator
- 5) Transmission Indicator

- 6) Zone 2 ON
- 7) Zone 2 SOS
- 8) Zone 2 OFF
- 9) Mounting Bracket

Power

Connect the 12v power supply through either the lower or side cable inlets, alternatively if you are drilling through an external wall and entering the control box through the rear, use a silicone sealant to prevent water ingress.

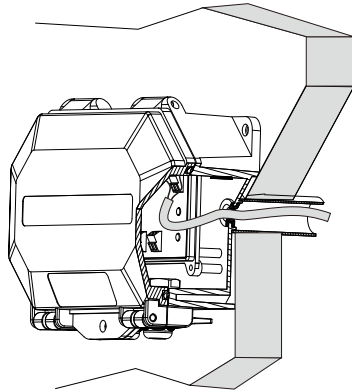

Connect the 12v supply to the circuit board taking careful attention to the positive and negative polarities

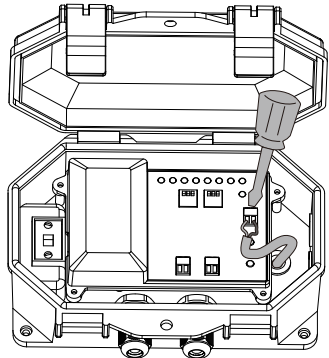

Loosen the screw, open the battery cover. Insert 2 'AAA' batteries to the battery compartment as indicated

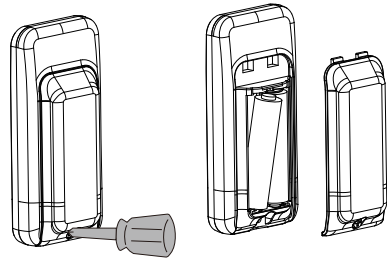

Installation

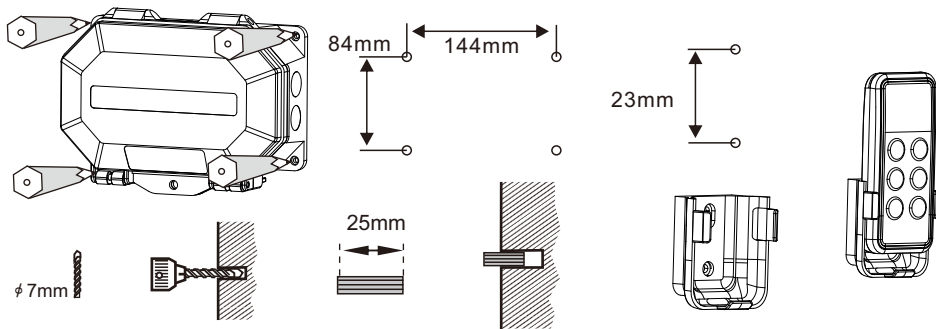

To mount the Control Panel

To mount the Remote Control

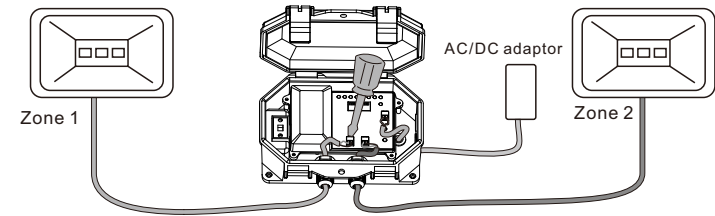

Connect the floodlight / siren or any other 12v accessory to the control box according to the indicated polarity using a small screwdriver, using the lower or side wire outlets, removing and replacing blanking plugs where not used.

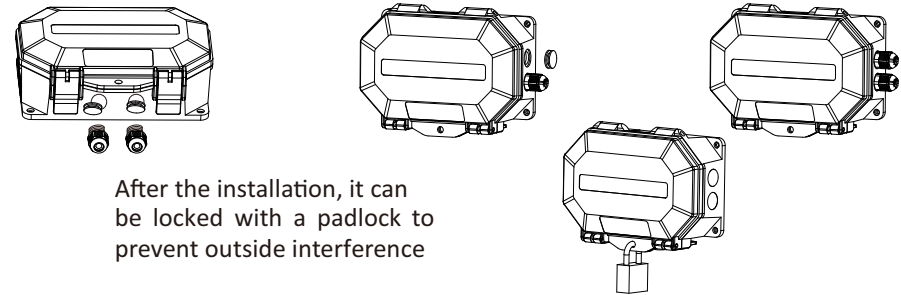

After the installation, it can be locked with a padlock to prevent outside interference

Pairing

This Outdoor Receiver is compatible with all other accessories in the Protect 800 range
8 transmitters can be paired (1 per channel)

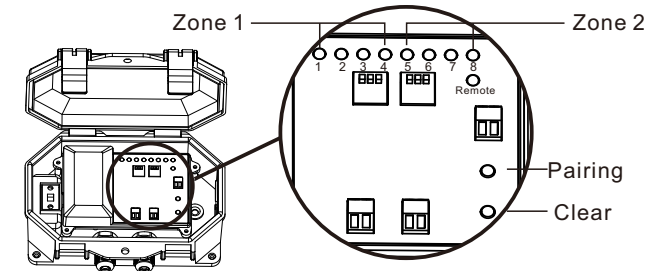

Step 1 : Insert a battery into the transmitter to be paired

Step 2: To enter the pairing mode, press and hold the pairing button for 3 seconds the LED in Zone 1 will light up.

Step 3: Press the pairing button again to move the light to the LED you wish to pair the transmitter to

Step 4: Once the LED you wish to pair is lit up, trigger the transmitter you wish to pair. If successful the LED will move onto the next position.

However if the LED flashes once and returns to the original position it is indicating the LED already has a transmitter paired

The last LED is for remote control pairing. When this LED is light, press any button on the remote controller unit to pair it